



Manholes

www.domcastmetals.com

401.010 Frame with 401.010 Type A/B Cover

Heavy Duty

Weight: 380 LBS

401.010 Frame with

Type A Solid Cover 2 Vents or

Type B Perforated Cover 30 Vents

Frame accepts:

402.010 Valve Chamber

Covers available in:

401.010SAN - Sanitary

401.010ST - Storm

401.010W - Water

401.010E - Electrical

Custom

Low Profile Frame Available

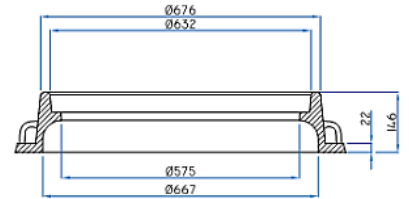
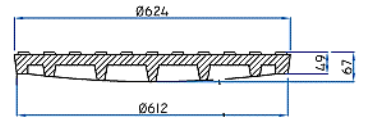
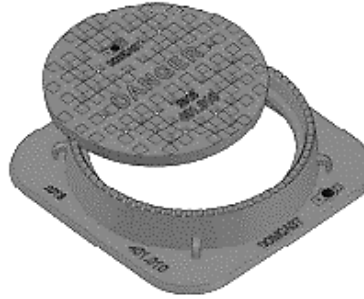

401.020 Circular Frame with Circular Cover

Heavy Duty

Weight: 380 LBS

Circular Frame with Circular Cover

Covers available in:

Custom

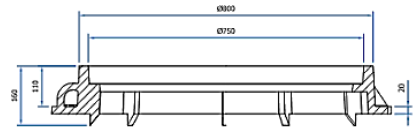
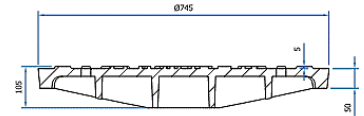
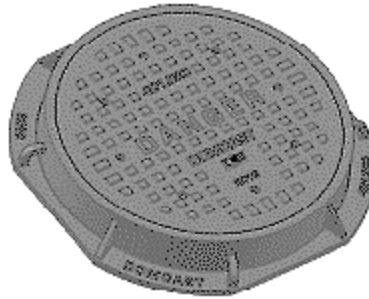

401.030 Square Frame with Watertight Circular Cover

Heavy Duty

Weight: 390 LBS

Square Frame with Circular Watertight Cover

Complete with Gasket and Stainless-Steel Bolts

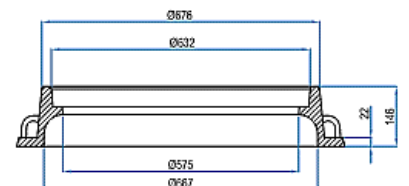
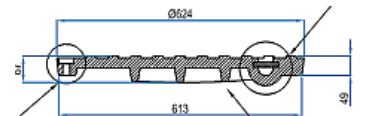
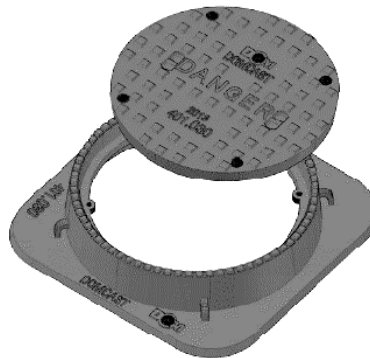

401.040 Raised Square Frame with Circular Cover

Heavy Duty

Weight: 450 LBS

Raised Square Frame with Circular Cover

Frame also accepts:

400.070 Fish Grate

401.060 Locking Cover

402.010 Valve Chamber

Covers available in:

Perforated

Sanitary

Storm

Water

Custom

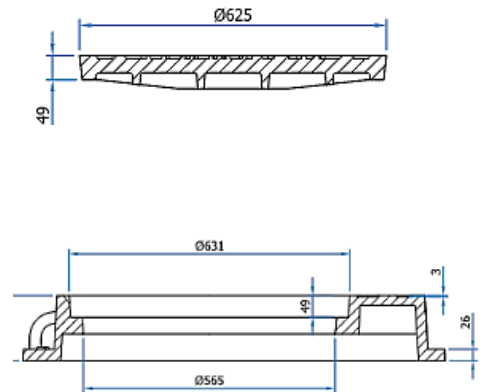
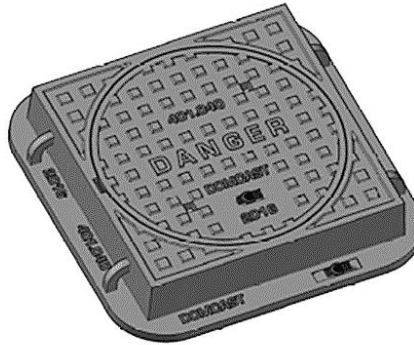

402.010 Square Frame, Circular Solid Cover with Plug For Valve Chamber

Heavy Duty

Weight: 450 LBS

Square Frame with circular cover and plug for valve chambers

Frame also accepts:

400.070 Herringbone Grate

400.070 Fish Grate

401.010 A/B

401.060 Locking Cover

402.020 Valve Chamber

Covers available in:

Sanitary

Storm

Water

Custom

Low Profile Frame Available

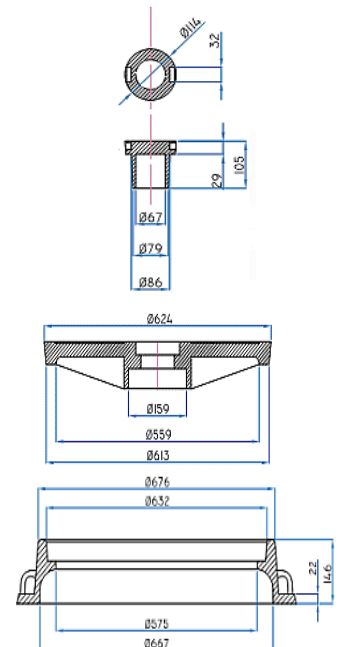
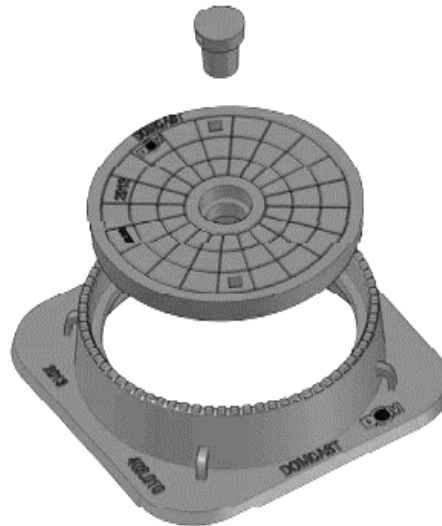

402.020 Raised Square Frame, Circular Cover with Plug for Valve Chambers

Heavy Duty

Weight: 450 LBS

Raised square frame, circular cover with
plug for valve chambers

Frame also accepts:

400.070 Herringbone Grate

400.070 Fish Grate

401.040 Type A/B Cover

401.060 Locking Cover

402.010 Valve Chamber

Sanitary Cover

Sewer Cover

Storm Cover

Water Cover

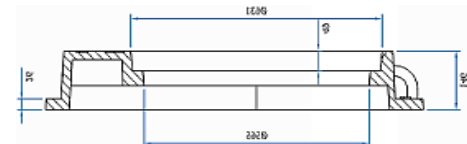
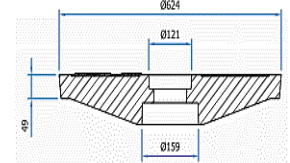
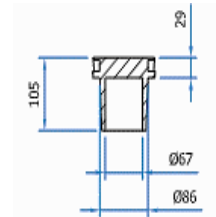
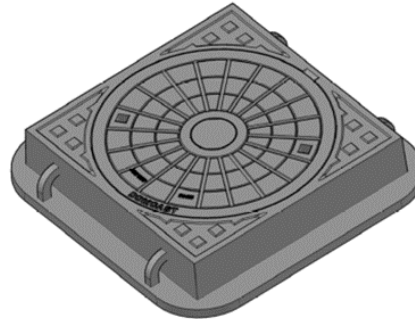

402.030 Rectangular Frame with Two-Piece Cover for Meter and Valve Chambers

Heavy Duty

Weight: 1359 LBS

Rectangular Frame and Two-Piece Cover

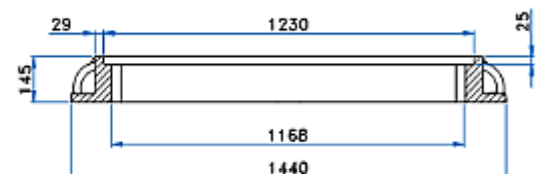
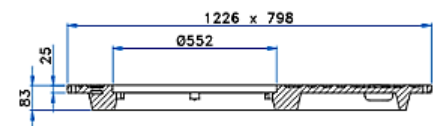
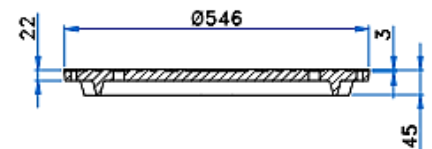
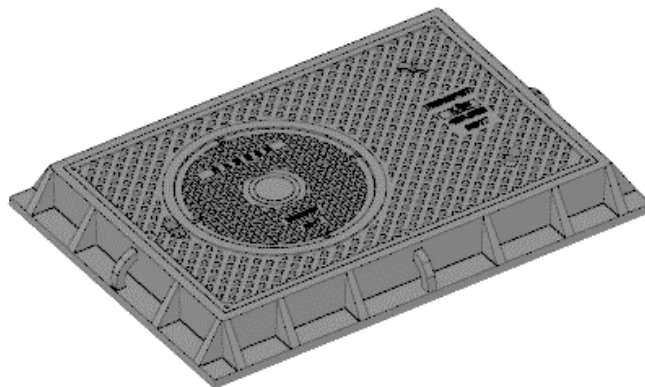

DF3248, Rectangular Frame with Two Piece Cover, Halton and York Region

Heavy Duty
Weight: 2035 LBS

Cover available in:

Halton Region Logo
York Region Logo
Custom

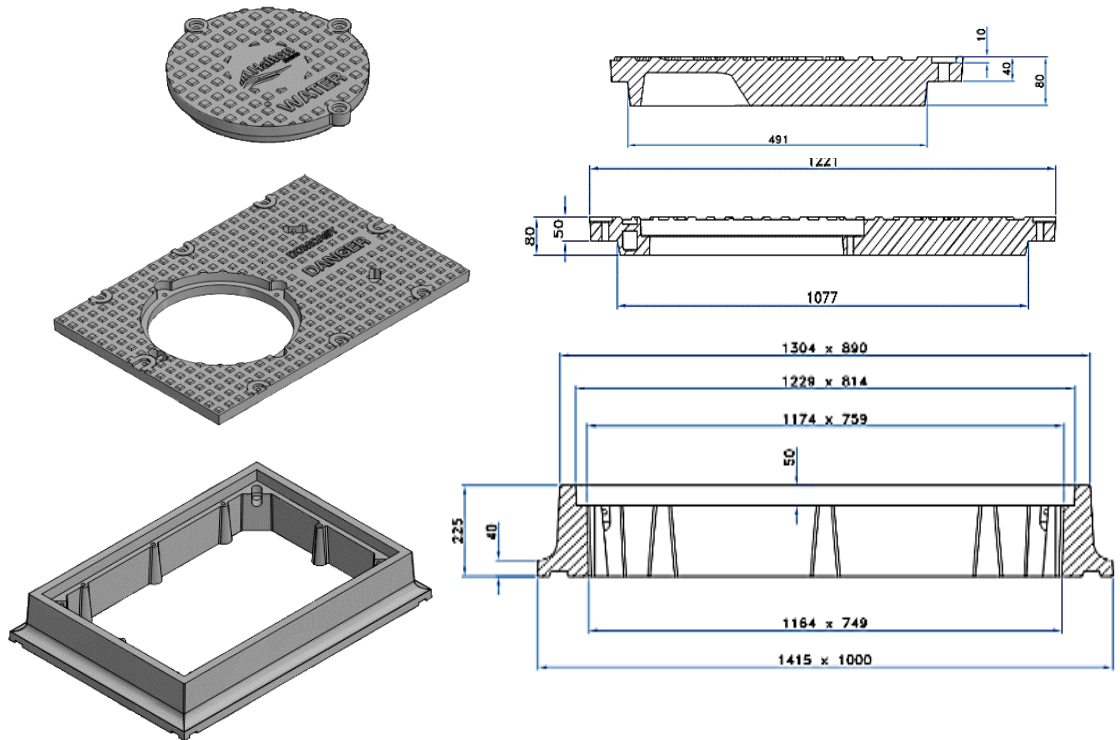

DF50M Self-Leveling 3 Piece Manhole

Heavy Duty
Self-Leveling 3-Piece Manhole
Weight: 415 LBS

Covers available in:

401.010 Type A

401.010 Type B

Sanitary

Storm

Water

Electrical

Custom

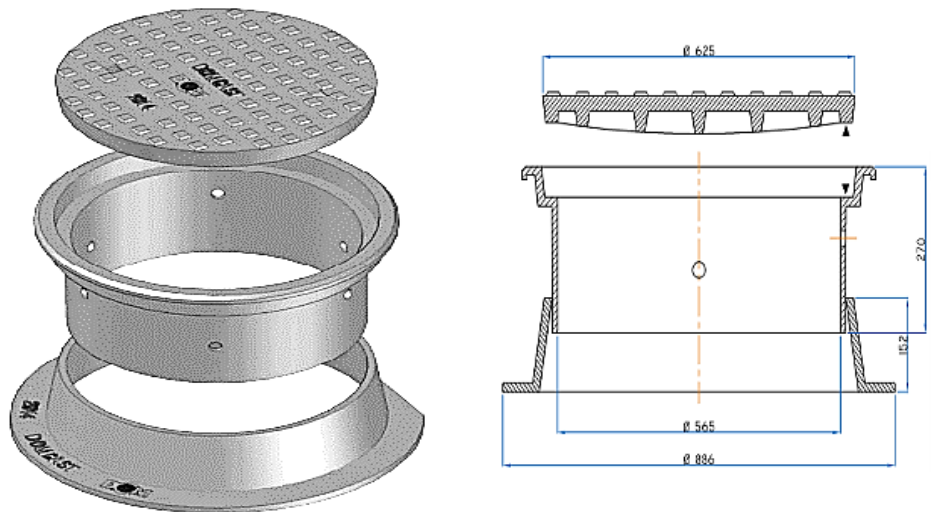

2112.010 12" Concrete Junction Box

Weight: 75 LBS

12" Cast Iron Frame and Cover
for Concrete Junction Box/Culvert
Bolted

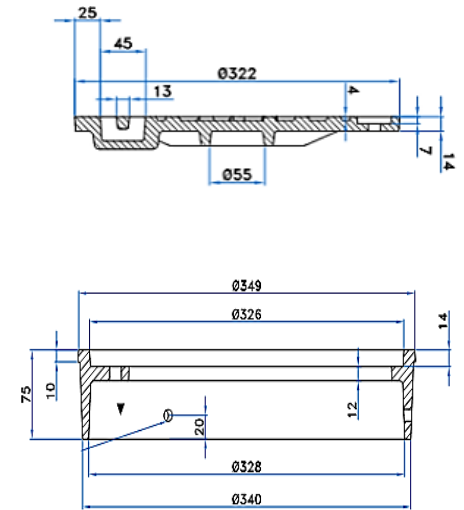
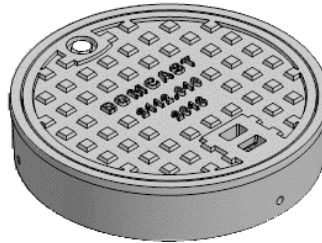

2112.020 18" Concrete Junction Box

Weight: 89 LBS

18" Cast Iron Frame and Cover
for Concrete Junction Box/Culvert
Bolted

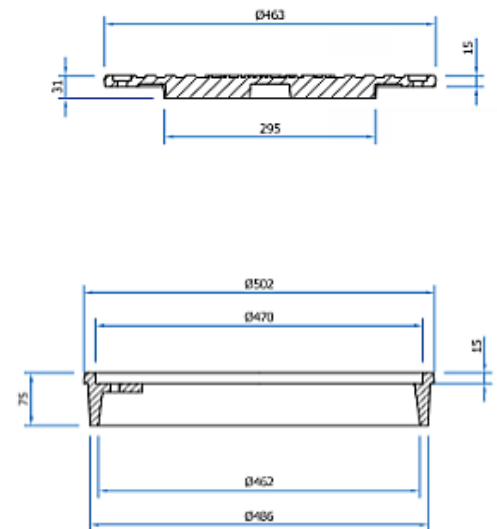
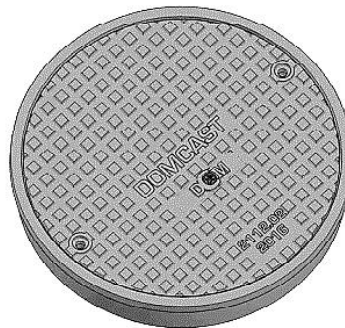

Ottawa Specification S25 Circular Frame / S24 and S24.1 Circular Covers

Heavy Duty
Weight: 380 LBS
Manhole Circular Frame / Cover
Covers Available in.
Fish Logo – Storm
Toilet Logo - Sanitary

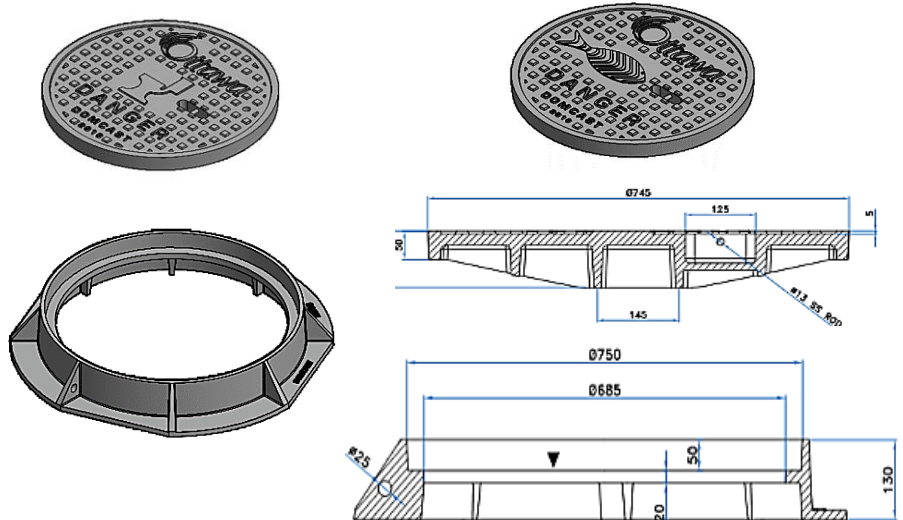

Ottawa Specification S25 Circular Frame / W15 Standard Round Cover with Sniffer Cap

Heavy Duty
Weight: 130 LBS

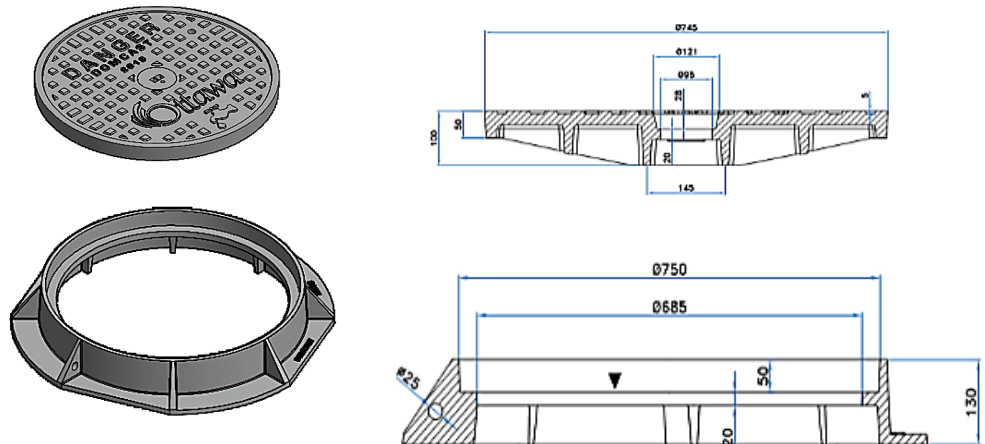

Moncton NB Specifications

DF50M-1 Self-Leveling 3 Piece Manhole

Heavy Duty
Self Leveling 3 Pc Design
Weight 390 LBS

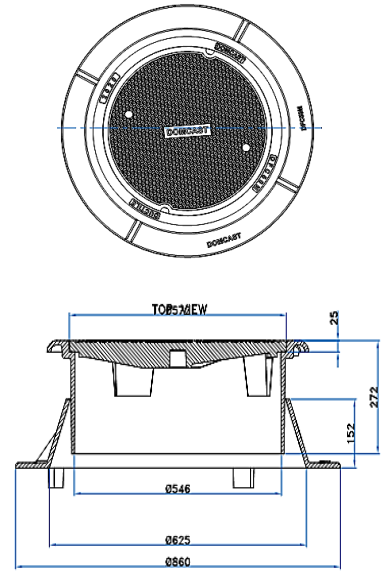

Halifax NS Specifications

DFHWSD-1460 Manhole Frame and Cover

Heavy Duty
Weight: 365 LBS

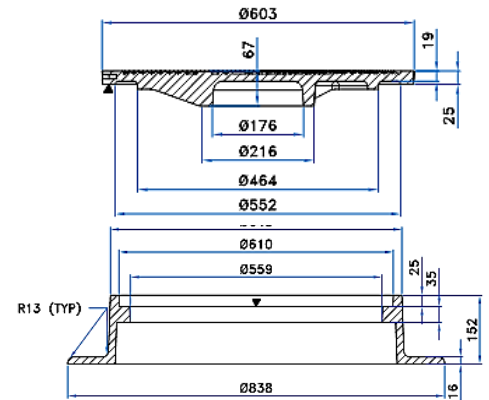
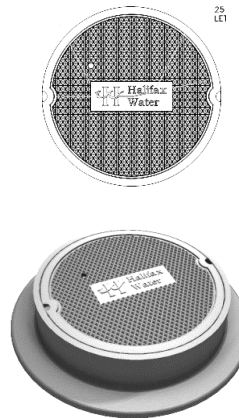

Halifax NS Specifications

DFHWSD-1462 R10 Cover

Self- Leveling 3-piece Manhole Frame and Cover

Heavy Duty
Weight: 365 LBS

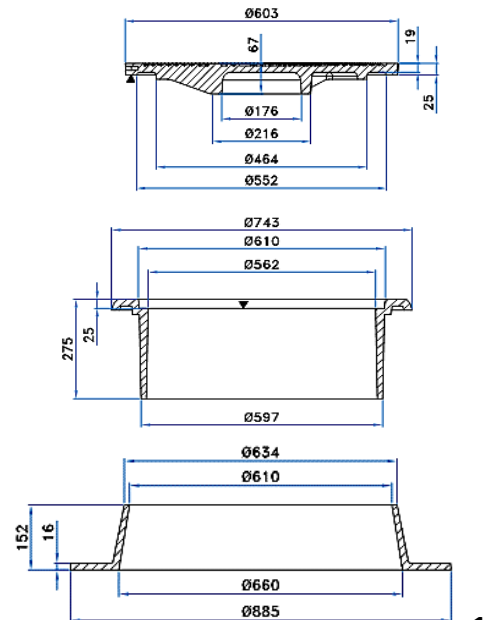

Saint John NB Specifications S045-207 Manhole Frame and Cover

Heavy Duty
Weight: 415 LBS

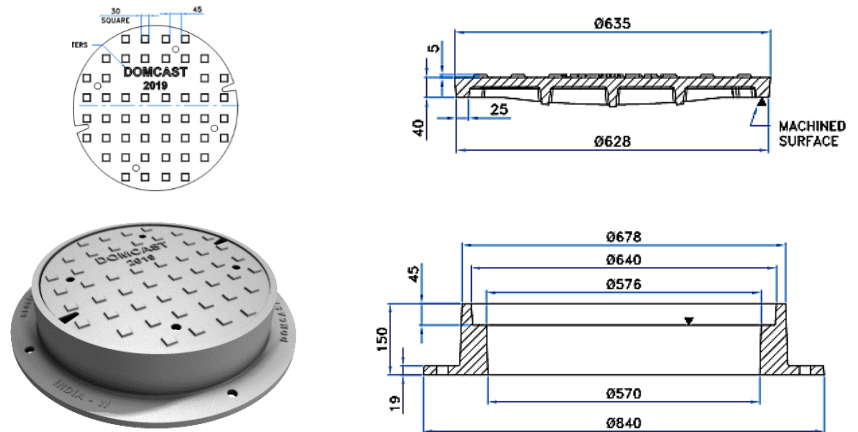

Saint John NB Specifications S045-207A Self-Leveling 3 Piece Manhole Frame and Cover

Heavy Duty
Weight: 415 LBS

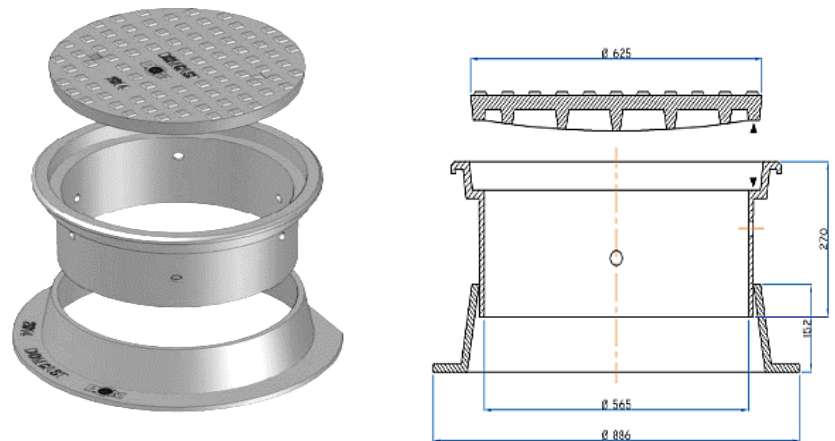

Saint John NB Specifications S045-108 Valve Chamber Frame and Cover

Heavy Duty
Weight: 520 LBS

